



Visit our  
EarthWay  
website to see the  
assembly video



#### SPREADER RATE SETTINGS

LBS PER 1000 SQUARE FEET	GRASS SEED	FERTILIZER SGN 240 (3/32")	SAND SGN 150 (1/16")
1 LB		9	7
2 LB	14	13	10
3 LB	16	16	13
4 LB	18	20	14
5 LB	20	22	16
8 LB		28	22

#### SIDE SPREAD CONTROL

#### SIDESPREAD CONTROL™

Patent U.S. 10,993,368

Your EarthWay spreader includes a patented feature to prevent fertilizer from being spread to the left side. To activate this feature, slide the lever below the hopper to the back (if standing behind the spreader) and position the left wheel 6"-12" from your sidewalk or border. This will not waste fertilizer like competitor designs that leave 7X the fertilizer inside the wheels from blocking material leaving the impeller.

#### PRIOR TO ASSEMBLY, YOU WILL NEED:

7/16" Wrench



Ratchet

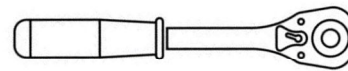

7/16" Socket Pliers

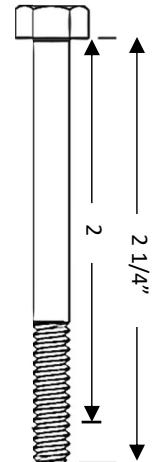

## HELPFUL HINTS

- Read the directions before assembly.
- If your spreader does not spread evenly, be sure "FRONT" on the GEARBOX points to the front of the spreader. **The impeller must turn clockwise when pushing forward.** Reversing the GEARBOX during assembly will cause issues.
- Your spreader is calibrated for three miles per hour, which is a brisk walking speed. Slower or faster speeds will change the spread pattern. Wet fertilizer will also change the spread pattern and flow rate. **Do not use powdered materials as it will damage the gearbox.**
- Gears are permanently lubricated at the factory. Do not open the GEARBOX or dirt may enter.

## SPREADER ASSEMBLY INSTRUCTIONS

**Step 1:** Remove the spreader and parts from the carton and arrange on the floor.

**Step 2:** Remove HOG RING and SPRING CLIP from AXLE and make sure the AXLE is installed correctly. The side that has the hole closest to the end of the AXLE should be located on the left side of the spreader (facing the back).

**Step 3:** Now, slide on AXLE BEARINGS making sure that the notch on the bearings matches up with the slot on the LOWER HANDLES as shown to the right.

**Step 4:** Slide AXLE BUSHING onto AXLE and into AXLE BEARING to both sides as shown in the bottom right image.

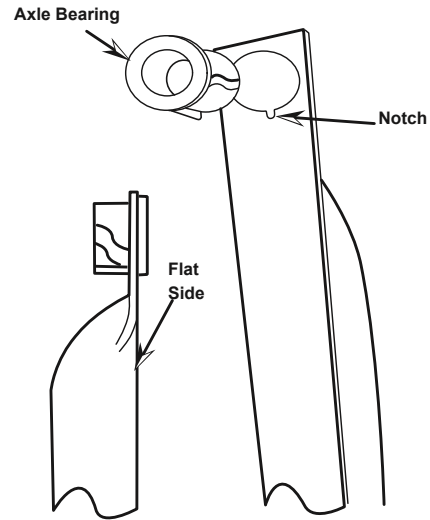

**Step 5:** Next, take the spreader and move it so the logo on the front of the hopper is facing away from you. Take (1) TIRE and push it onto the AXLE from the right side of the spreader. This will be your drive wheel.

**Step 6:** Line up the hole in the TIRE hub to the hole in the AXLE closest to the LOWER HANDLES and secure with your SPRING CLIP.

**Step 7:** Now, take the remaining TIRE and push it on to the AXLE from the left side of the spreader. This will be your coast wheel.

**Step 8:** Line up the hole in the TIRE hub to the hole in the AXLE closest to the end and secure with your HOG RING.

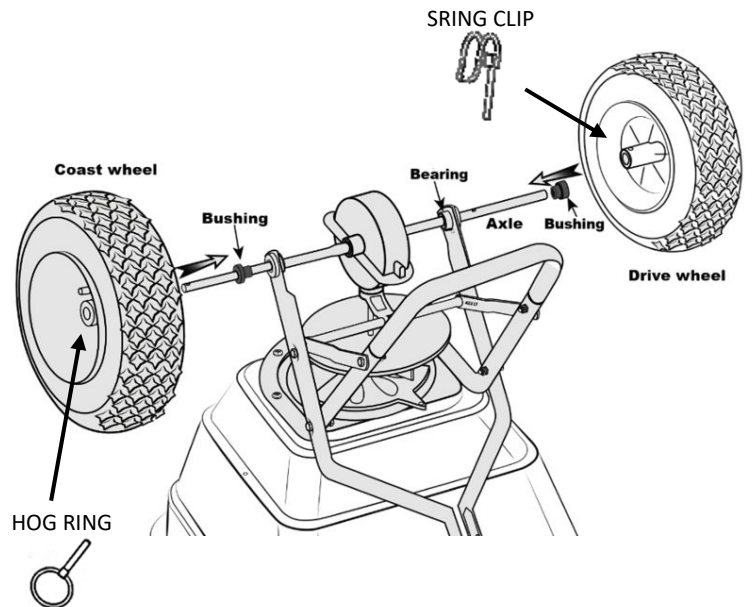

**Step 9:** Now remove the PIVOT BRACKET from THE LOWER HANDLES. Keep the 1/4 -20 x 2" bolts and locknuts for use in reinstallation.

**Step 10:** Install HANDLE SHAFT INTO LOWER HANDLES and then reattach the PIVOT BRACKET assembly as shown onto the LOWER HANDLES using two 1/4 -20 x 2" bolts and locknuts. **TIGHTEN BOLTS AND NUTS NOW.**

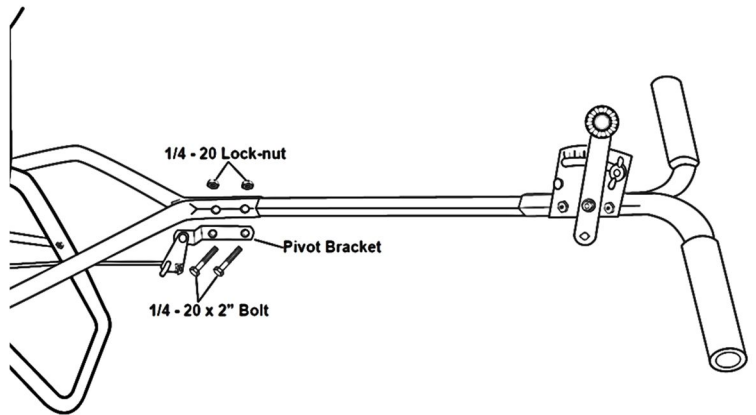

**Step 11:** Remove one 1/4-20 Hex Nut from the CONTROL ROD. Next, push LEVER forward to setting "0" to help align the CONTROL ROD with hole in PIVOT BRACKET, pull LEVER backward to insert CONTROL ROD through hole in PIVOT BRACKET. Now install 1/4-20 regular nut on to CONTROL ROD.

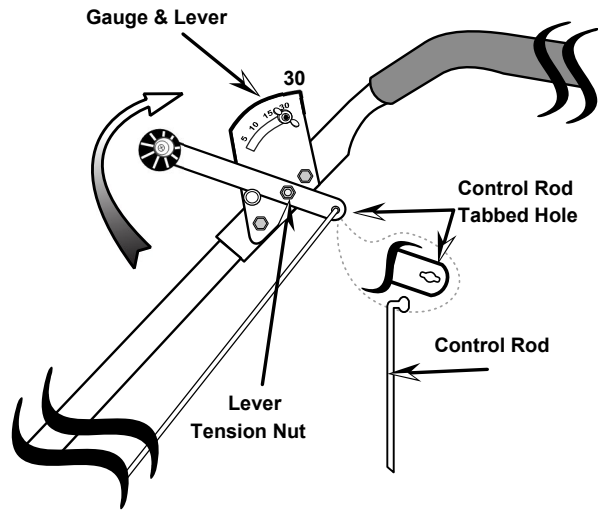

**Step 12:** Insert the PIVOT ROD into the ROD CLIP that is installed in the PIVOT BRACKET.

**Note:** Make sure to ensure that the ROD CLIP is installed as shown to the right.

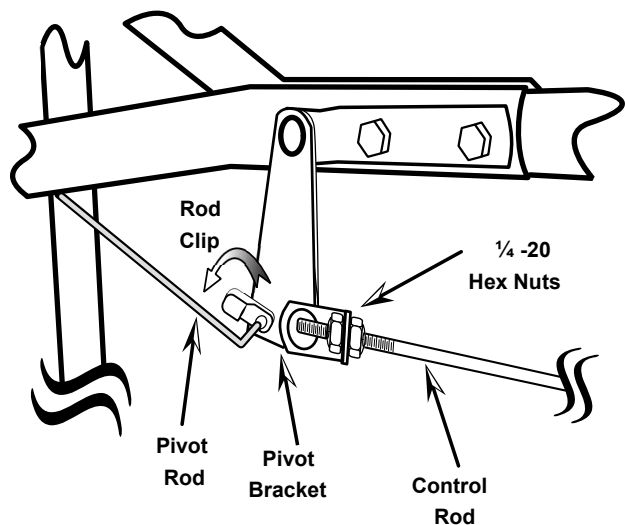

**Step 13:** Insert PIVOT ROD into SHUT-OFF PLATE as shown. Turn to lock in place. Tighten all hardware.

**Step 14:** Next, insert other end of PIVOT ROD into PIVOT BRACKET assembly as shown. Turn to lock in place.

**Step 15:** Lastly, take AGITATOR and slide it through the hole located in the SHAFT inside the hopper. Place debris screen flat inside HOPPER letting it rest on the first indentation.

**NOTE:** The HIGH-OUTPUT (BLUE) and Low-OUTPUT (Black) Trays do not use the AGITATOR PIN.

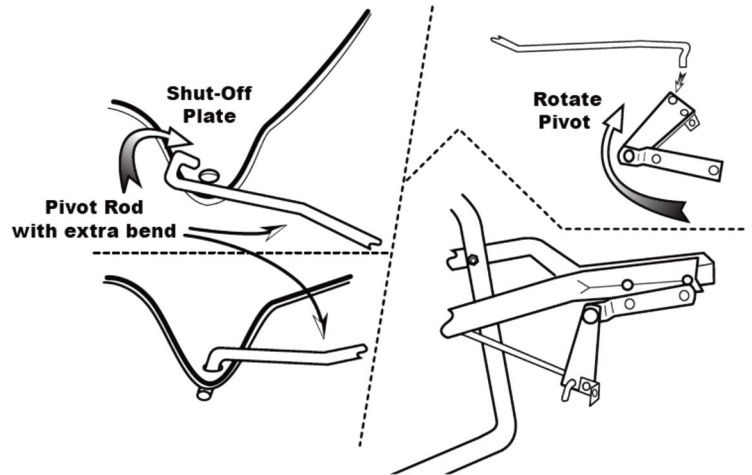

## OPERATING INSTRUCTIONS

- ☑ Obtain proper setting for material to be used from the enclosed SETTING MATRIX included with this spreader, or from our web site under the MANUALS SECTION.
- ☑ Set stop bolt on rate gauge assembly to the proper rate setting.
- ☑ While pushing spreader forward, pull control lever back to stop bolt, to stop spreading, push lever forward to close flow holes before you stop moving.
- ☑ When finished, empty any remaining material from hopper, rinse spreader, apply coating of light oil to all metal parts. The gearbox is sealed and is factory lubricated.

### SIDESPREAD CONTROL™

The **SideSpread-Control** is a patented innovation that is superior to side deflectors. Side deflectors block material leaving the impeller. This blocked material is now consolidated into a 2-3" wide path on the left inside wheel of your spreader. This equates to wasted fertilizer, dark green stripes, and in some cases this extra fertilizer (seven times) will damage the lawn.

**SideSpread-Control** maintains the correct application rate while not placing material on driveways, sidewalks, flowerbeds, or worse, the storm drains in your street. This saves you money and keeps you from damaging your lawn.

To engage **SideSpread-Control**:

- 1) Locate the lever on under the right side of the hopper.
- 2) Slide the control lever from the front to the back.
- 3) Position the left wheel of your spreader 6"-12" from the sidewalk, flowerbed, or driveway and spread as normal.
- 4) When you have completed this spreading pass, close the control lever to "0", and then open the **SideSpread-Control™** by sliding the control lever from back to the front, for a **FULL**, 180 degree spread pattern.

## TRAY INSTALLATION

**\*Installation instructions may vary depending on the tray you are using. Please read all instructions carefully.**

**Step 1:** Install TRAY ③ from the top downwards into the hopper (see figure ⑤) positioning the center hole of the tray over the PINION SHAFT from the gear box with the PIVOT ROD through the bottom of the hopper and facing toward the spreader's handlebar. For ease of locating into position the shut-off of the chosen tray is best in the open position, with the exception of the red **STANDARD-OUTPUT TRAY** where the two adjustable throwing ports are best in the closed position.

**Step 2:** Ensure the hopper is clean and there is no debris trapped around the tray mounting area.

**Step 3:** Install the PIVOT ROD CLIP ① into the Shut-off plate on the selected TRAY ③.

**Step 4:** Insert the PIVOT ROD ② into the CLIP ①.

**NOTE:** The CLIP ① may have a burr in the hole, use a Phillips screwdriver to remove the burr ④. Pliers may be required to help squeeze the PIVOT ROD ② into the CLIP ①.

**Step 5:** When the ROD ② is secure inside the CLIP ① push the free end of the CLIP ① over the PIVOT ROD ② to firmly secure the rod to the clip.

**Step 6:**

**NOTE:** The gearbox can be moved along the axle to ease aligning of the tray hole and the PINION SHAFT.

**Step 7:** Once the tray is in place check that the tray is sealed and flush against the hopper sides. To check if the tray is properly located, push the tray edges downwards.

**Step 8:** Install the two quarter turn fasteners (see figure ⑥) through the two exposed tray holes and push down and twist a quarter turn to secure.

**Step 9:** Lastly, connect the free end of the PIVOT ROD ② into the PIVOT linkage at the bottom of the CONTROL ROD. Position the CLIP ① into the free hole and push the PIVOT ROD ② into the clip.

**TIP:** The CLIP ① may have a burr in the hole, use a Phillips screwdriver to remove the burr (see figure ④).

**Step 10:** When the PIVOT ROD ② is positioned inside the CLIP ① push the free end of the CLIP ① over the PIVOT ROD ② to firmly secure the rod and the clip together.

**HIGH-OUTPUT F13130HKIT**  
Blue Tray  
install Pivot Rod from the bottom to the top

**LOW-OUTPUT F13130LKIT**  
Black Tray  
install Pivot Rod from the top to the bottom

**STANDARD-OUTPUT PRO F13130DKIT**  
Red Tray  
install Pivot Rod from the bottom to the top

Debur Rod Clip

Shut-Off End

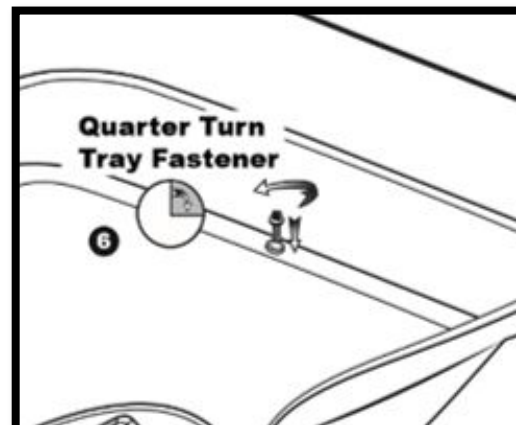

## SPREADER CALIBRATION INSTRUCTIONS

### HIGH-OUTPUT and LOW-OUTPUT TRAY:

Make sure the drop holes in the bottom of the hopper are **FULLY CLOSED** when the RATE CONTROL LEVER is resting on Stop #0.

If the shut-off is not set correctly, please adjust CONTROL ROD at the PIVOT to position the shut-off for **FULLY CLOSED** at position at the Stop #0 on the RATE CONTROL LEVER. *As a side note, the HIGH-OUTPUT and LOW-OUTPUT TRAYS do not include or use a horizontal agitator.*

#### *Calibration Adjustment*

Review the CONTROL LEVER position to confirm that it is set so that the forward edge of the LEVER is resting at #0 (the stop) and the drop holes are closed. Move the spreader back & forth to ensure that the cam is positioned to allow the oscillating shut-off to close fully. If the shut-off is not properly positioned, you will need to adjust the CONTROL ROD at the PIVOT BRACKET shown below.

**TIP:** If your shut-off is not able to **CLOSE** fully, loosen the top nut a few turns, then tighten the lower nut so that it allows you to push the **shut-off fully closed**. Next, tighten each nut so that they contact the PIVOT BRACKET without moving it, and then carefully tighten each nut fully so they do not loosen during use. Recheck adjustment as outlined above.

### STANDARD-OUTPUT TRAY:

Make sure the drop holes in the bottom of the hopper are **FULLY OPEN** when the RATE CONTROL HANDLE is on #30. If the shut-off is not set correctly, please adjust CONTROL ROD at the PIVOT to position the shut-off for **FULLY OPEN** hopper position at #30 on the RATE CONTROL LEVER. Install the horizontal AGITATOR through the PINION SHAFT in the hopper bottom. Finally, install the DEBRIS SCREEN onto the Quarter-turn fasteners and push down to snap and secure.

Review the CONTROL LEVER position to confirm that it is set so that the rear edge of the LEVER is resting at #30 (the stop) and the drop holes are open. If the shut-off is not properly positioned, you will need to adjust the CONTROL ROD at the PIVOT BRACKET shown below. **TIP:** If your shut-off is not able to **OPEN** fully, loosen the bottom nut a few turns, then tighten the upper nut so that it allows you to push the **shut-off fully open**. Next, tighten each nut so that they contact the PIVOT BRACKET without moving it.

Then, if the CONTROL LEVER does not stay in position causing the setting rate to change without your intervention, you can adjust the drag on the LEVER by tightening or loosening the nut shown to the right until the drag is appropriate.

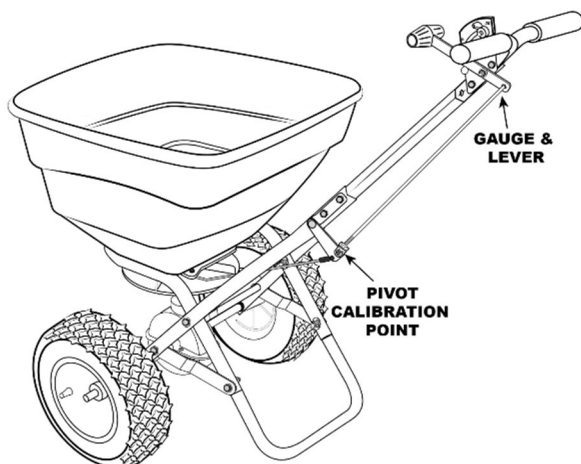

# HANDLE ADJUSTMENT INSTRUCTIONS

TALL OPERATOR CONFIGURATION – with the four handle holes, use the bottom two holes for the gauge and use the top two holes for the spacer.

## STANDARD POSITION

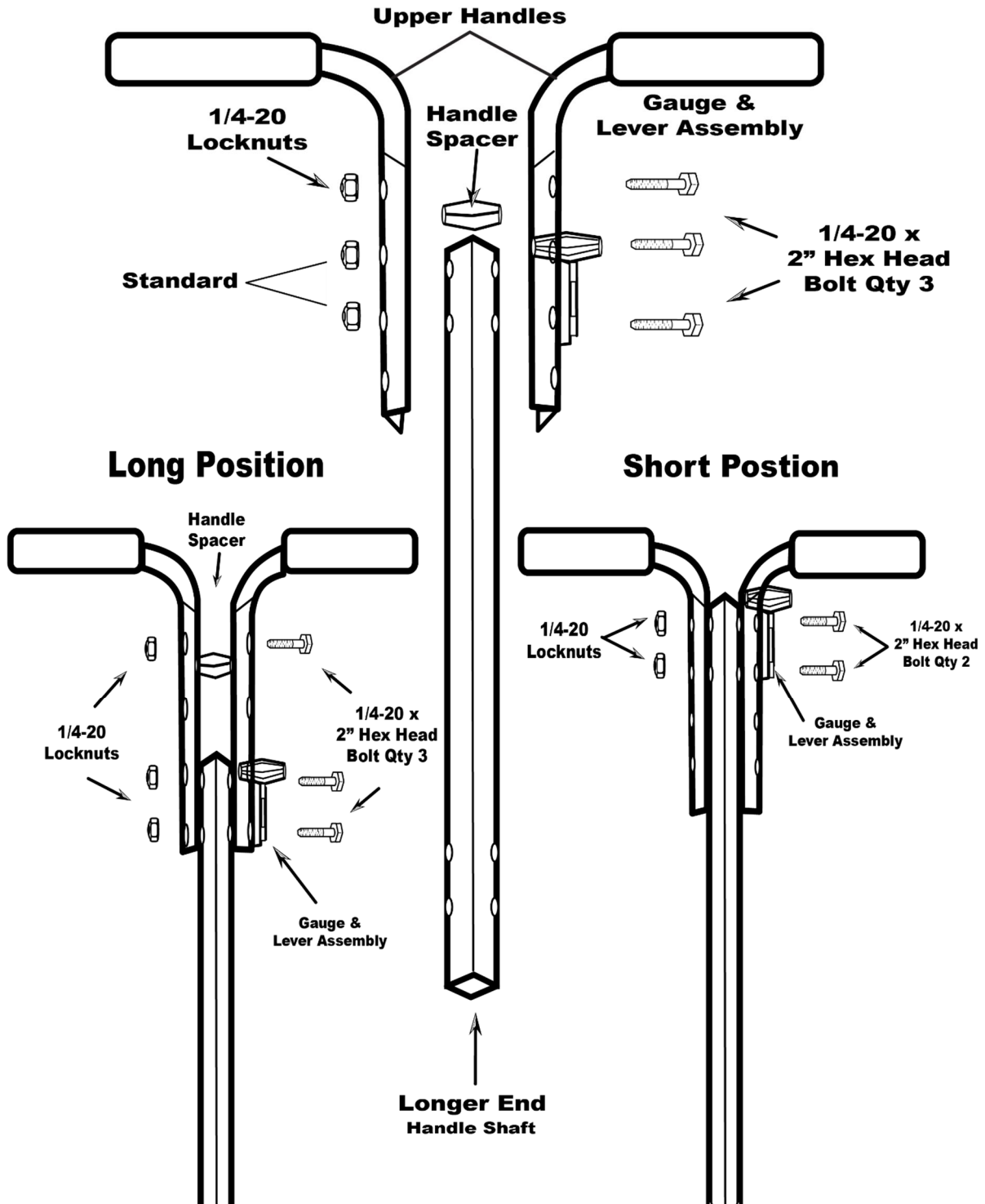



## HOW TO ORDER PARTS

Call or Email: TURF DEPOT 800-305-9255 or [earthway@turfdepot.com](mailto:earthway@turfdepot.com)

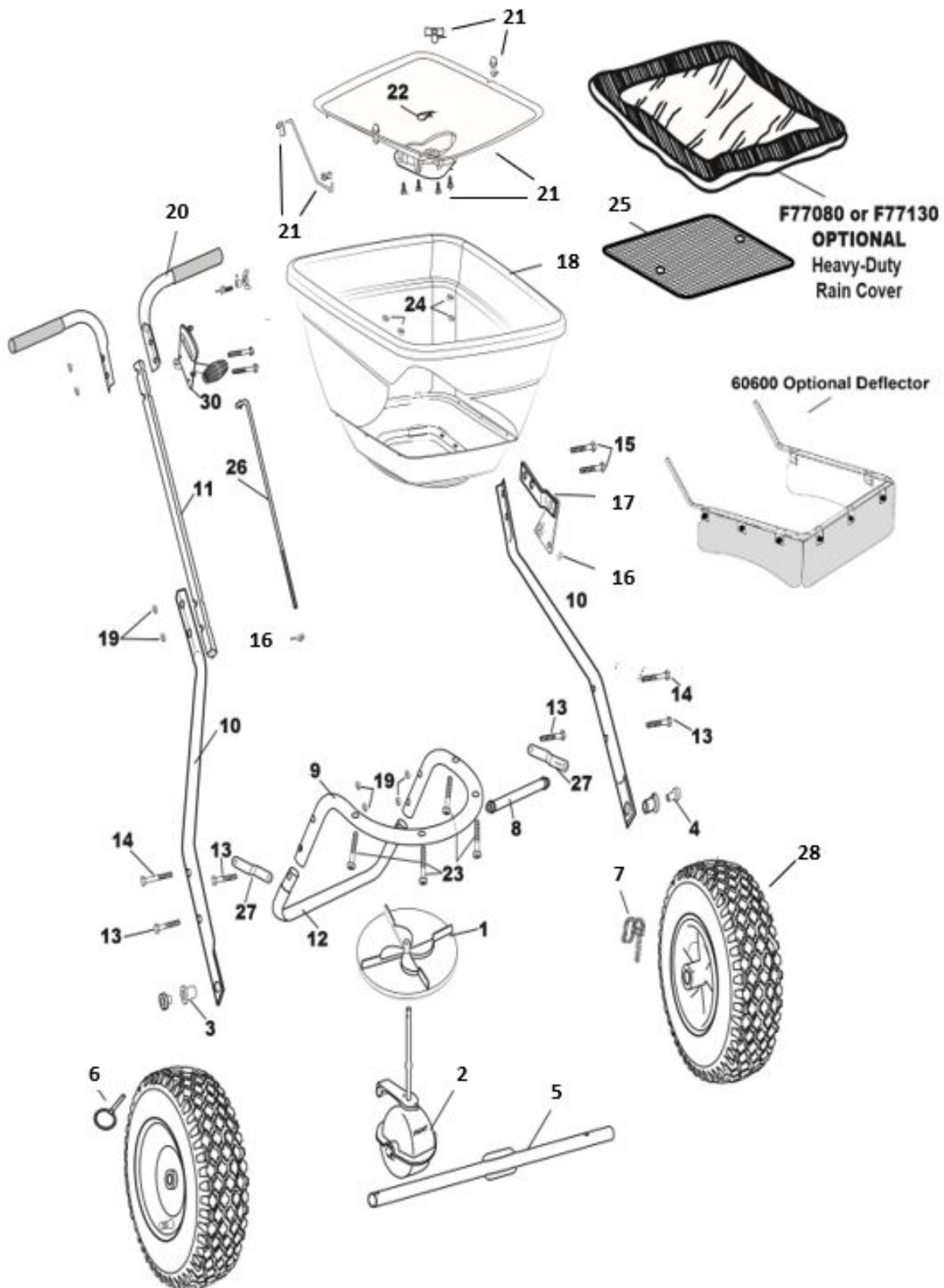

<b>F80/F80H Broadcast Spreader Parts List</b>		
<b>KEY</b>	<b>PART #</b>	<b>DESCRIPTION</b>
1	12110	IMPELLER 9" ROUND DISHED
2	F60333	GEAR BOX ASSEMBLY FLEX -SELECT
3*	12148	AXLE BEARING
4*	12152	AXLE BUSHING
5	24500	AXLE
6*	33115	HOG RING
7*	33113	SPRING CLIP
8	25228	CROSS BRACE
9	25108	FRAME
10	25222	LOWER HANDLE
11	25223	HANDLE SHAFT
12	25723	FRAME FOOT
13	31100	1/4-20 X 1 1/2 HHMS ZINC
14	31106	1/4-20 X 2 1/4" HHCS ZINC
15	31120	1/4-20 X 2" HHCS ZINC
16	32100	1/4-20 HEX NUT ZINC
17	60300	PIVOT & BRACKET ASSEMBLY
18	F13105	HOPPER
19	32103	1/4-20 NYLON LOCKNUT ZINC
20	60175	UPPER HANDLE SQUARE W/GRIP
21	F13130KIT	STANDARD OUTPUT TRAY (includes key 22)
22*	33117	AGITATOR
23	36214	1/4-20 X 1 1/2" PHPMS SS
24	36300	1/4-20 NYLON LOCKNUT SS
25	F40003	DEBRIS SCREEN (included with Standard Tray only)
26	F44251	CONTROL ROD
27	44249	FRAME BRACE
28	70138	PNEUMATIC TIRES
29	F13130H-KIT	HIGH OUTPUT TRAY
30	60298	GAUGE & LEVER ASSEMBLY
*	F38081	HARDWARE PKG (Keys 3, 4, 6, 7, 22)
Optional	60600	SIDE DEFLECTOR
Optional	F77080	HEAVY DUTY RAIN COVER

---

## CUSTOMER SERVICE

---

[SUPPORT@EARTHWAY.COM](mailto:SUPPORT@EARTHWAY.COM) | [www.EARTHWAY.com](http://www.EARTHWAY.com) | 1009 Maple Street, Bristol, IN 46507

---

## ONE YEAR WARRANTY

---

### Limited Warranty

EarthWay Products, Inc. provides this limited warranty that this product is free of defects in original workmanship and materials for a period of one year to the end user with the original purchase receipt. If a manufacturing non-conformance is found, EarthWay Products, Inc. at its discretion will repair or replace the part(s)/product at no charge provided the failure is not the result of incorrect installation, mishandling, misuse, tampering, improper storage, or normal wear and tear as determined by EarthWay. Due to the corrosive nature of most fertilizers and ice melt products, EarthWay Products, Inc. makes no warranty against and specifically excludes part(s) or product degradation or failure due to corrosion or its effects .

EarthWay at its discretion may require that the part(s) or product be returned along with the original purchase receipt for examination and compliance with the terms of this limited warranty. Do not return any product without first receiving authorization from EarthWay Products, Inc. IN NO EVENT SHALL EITHER PARTY BE LIABLE TO THE OTHER FOR SPECIAL, INDIRECT, INCIDENTAL OR CONSEQUENTIAL DAMAGES, EVEN IF SUCH PARTY SHALL HAVE BEEN ADVISED OF THE POSSIBILITY OF THE SAME. To seek remedy under this limited warranty, contact EarthWay Products, Inc. at [support@earthway.com](mailto:support@earthway.com) or write to EarthWay Products, Inc. 1009 Maple Street, Bristol, IN 46507 and describe the nature of the manufacturing defect. SPECIFIC LIMITATIONS: This limited warranty covers only the part(s) or product; any labor charges associated with repair or replacement of non-conformances are specifically excluded.

The above-listed warranty procedure is a condition precedent to bringing any legal action to enforce this limited warranty. Any action to enforce any portion of this limited warranty must be commenced within ninety days after the expiration of the limited warranty coverage period. Any performance of repairs will not suspend this limitation period from expiring, unless state law provides otherwise. Any performance of repairs after the limited warranty coverage period has expired, or performance of repairs regarding anything excluded from coverage under this limited warranty shall be considered “good will” repairs, and they will not change the express terms of this limited warranty or extend the limited warranty coverage period.

Exclusive jurisdiction for deciding legal disputes relating to alleged breach of warranty or representations of any nature relating to this limited warranty must be filed in the courts of Elkhart County within the State of Indiana. Any and all claims, controversies, and causes of action arising out of or relating to this limited warranty, whether sounding in contract, tort or statute, will be governed by the laws of the State of Indiana, without giving effect to any choice or conflict of law provision or rule.

NO OTHER WARRANTY, EXPRESS, IMPLIED OR STATUTORY, SHALL APPLY, INCLUDING, BUT NOT LIMITED TO, ANY IMPLIED WARRANTY OF MERCHANTABILITY, APPLICATION OR FITNESS FOR A PARTICULAR PURPOSE, OR ANY OTHER WARRANTY OBLIGATION ON THE PART EARTHWAY, AND ALL SUCH WARRANTIES ARE EXPRESSLY DISCLAIMED. In the event that applicable law prevents the disclaimer of any implied warranties, then such implied warranty shall be limited to the fullest extent permitted by law. Without limiting the foregoing, if applicable prevents the disclaimer of any such implied warranties, this limited warranty limits the period of time in which a claim for breach of implied warranties, including but not limited to the implied warranty of merchantability or fitness for a particular purpose, may be filed. In such event, any claim for breach of implied warranty must be brought before the expiration of this express limited warranty’s one year term.